

CREATE
YOUR STYLE
with SWAROVSKI ELEMENTS



DESIGN PROJECT

VALENTINE TIE PIN
“BE MY VALENTINE”



VALENTINE TIE PIN "BE MY VALENTINE"

SWAROVSKI ELEMENTS

Article	Product Group	Article No.	Amount	Size	Color	Color Code
	Flat Backs No Hotfix	2058	2 pcs.	SS3	Crystal F	001
	Flat Backs No Hotfix	2058	4 pcs.	SS5	Crystal F	001
	Flat Backs No Hotfix	2058	2 pcs.	SS6	Crystal F	001
	Flat Backs No Hotfix	2058	3 pcs.	SS6	Jet F	280
	Flat Backs No Hotfix	2058	2 pcs.	SS8	Jet F	280
	Flat Backs No Hotfix	2058	2 pcs.	SS10	Crystal F	001
	Pendants	6262	1 pc.	17 mm	Crystal Satin	001 SAT

Supplies & Tools

Supplies
1x Tie Pin, Silver

Tools
Glue
Tweezers

STEP 1: Glue a Swarovski Pendant article 6262 17mm Crystal Satin onto a tie pin as shown.

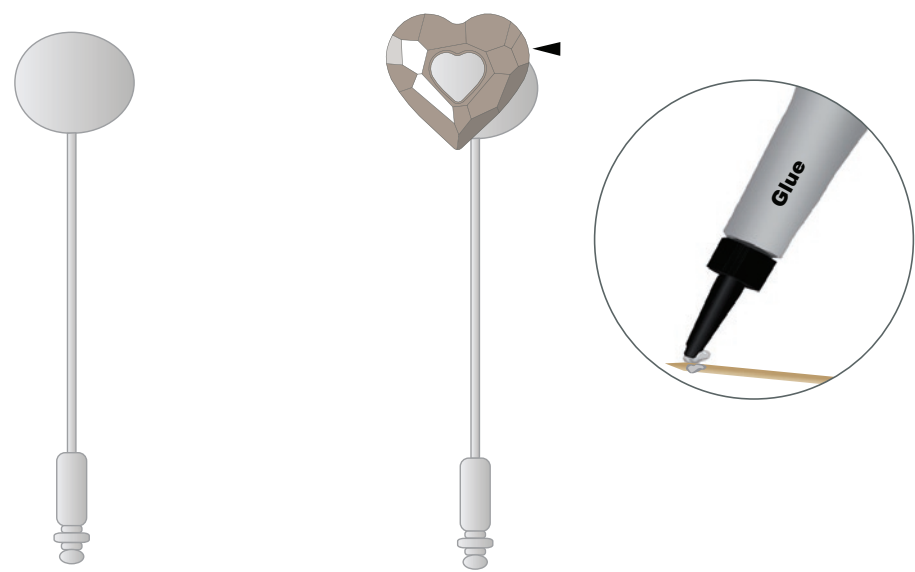

STEP 2: Glue the SWAROVSKI ELEMENTS Flat Backs No Hotfix article 2058 assortment onto the tie pin using tweezers.

